

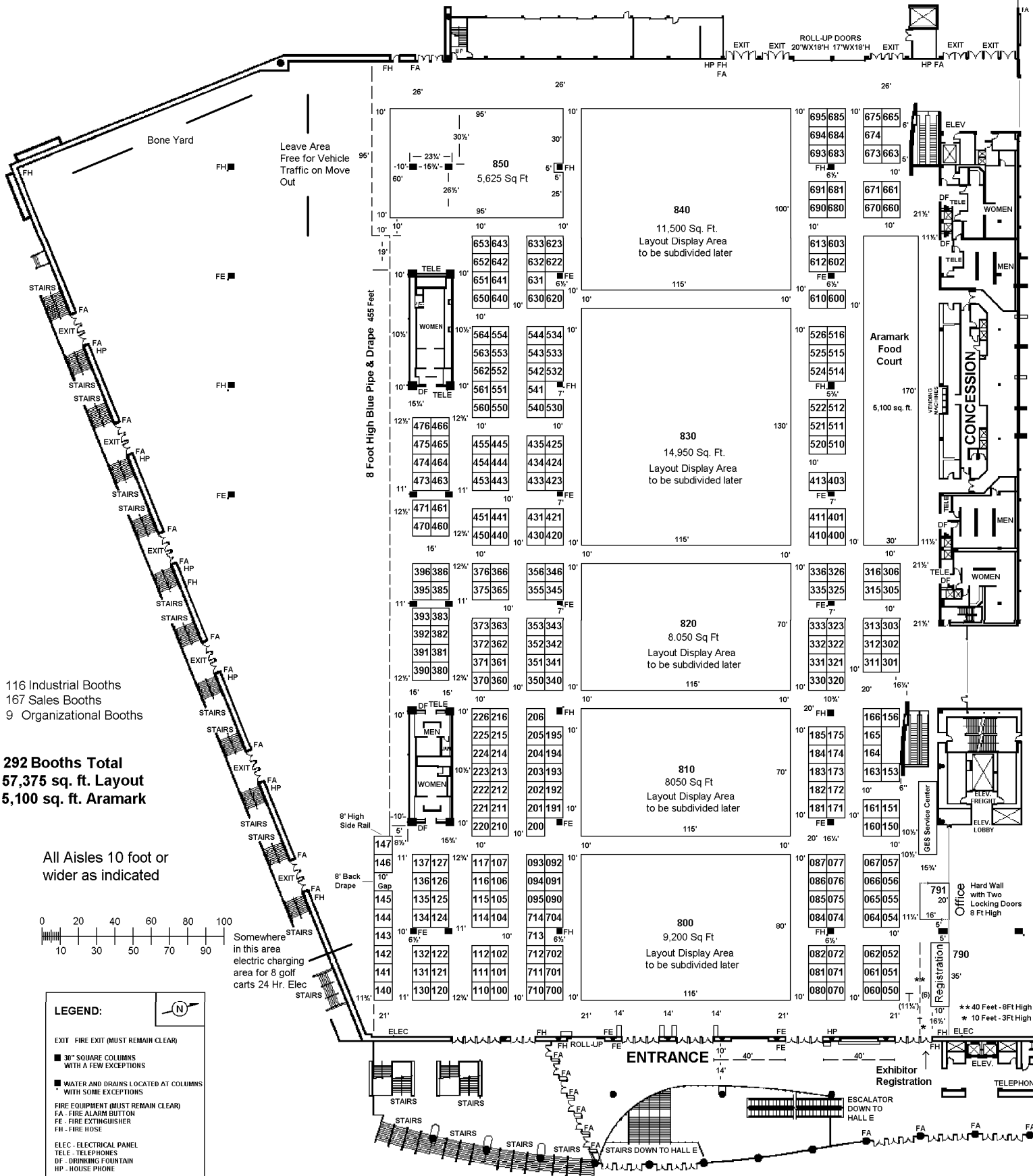

NATIONAL TRAIN SHOW
National Model Railroad Assoc.
Anaheim Convention Center
Anaheim, California
July 18 - 20, 2008



Hall D
Original May 5, 2007
Revision #5, 7 May 2008



116 Industrial Booths
 167 Sales Booths
 9 Organizational Booths

292 Booths Total
57,375 sq. ft. Layout
5,100 sq. ft. Aramark

All Aisles 10 foot or wider as indicated

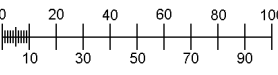

Somewhere in this area electric charging area for 8 golf carts 24 Hr. Elec

LEGEND:

- EXIT FIRE EXIT (MUST REMAIN CLEAR)
- 30" SQUARE COLUMNS WITH A FEW EXCEPTIONS
- WATER AND DRAINS LOCATED AT COLUMNS WITH SOME EXCEPTIONS
- FIRE EQUIPMENT (MUST REMAIN CLEAR)
 - FA - FIRE ALARM BUTTON
 - FE - FIRE EXTINGUISHER
 - FH - FIRE HOSE
- ELEC - ELECTRICAL PANEL
- TELE - TELEPHONES
- DF - DRINKING FOUNTAIN
- HP - HOUSE PHONE

** 40 Feet - 8 Ft High Blue P&D
 * 10 Feet - 3 Ft High Blue P&D